



popolini

organic parenting since 1991

Content

Cloth nappy guide.....	4
Who we are.....	6
Cloth nappies	7
Systems	8
Basic equipment.....	9
Newborn MiniFit	10
Newborn MiniSnap	12
OneSize.....	14
UltraFit	16
Panda.....	18
TwoSize	20
Prefold	22
Knitted nappy.....	24
Tips cloth nappies	25
EasyFree	26
Covers.....	30
PopoWrap	31
Vento.....	32
EasyWrap	33
WoolWrap	34
WoolPant	35
Accessoires.....	36
Nappy washing instructions.....	40
Wool care instructions.....	42
Our certificates	43



A guide to cloth nappies – why?

There are various types of cloth nappies. And every child is different. This guide gives you insights into the diversity of our washable nappies – to find the best option for your little one.

How do you use them?

We also added practical instructions, tips and personal experiences around our products. You can always look them up again at a later moment for guaranteeing a successful cloth nappy journey.

Enjoy reading!

Your popolini team



Who we are

„The first address for a sustainable life - from the very beginning.“

Founded in 1991 in Sigrid and Gerhard Feyferlik's private basement, popolini now encompasses a growing team of over 100 employees in 4 countries. Now the family business is successfully entering the second generation.

The company's principle yet remained the same: We focus on quality! All baby textiles are certified organic, highly functional and they support our children in growing up naturally.

Over the years, we gained a lot of experiences in this field – with our own children, our distributors and customers. On top of that, we focus on collaborating with hospitals, midwives as well as nursing and carrying advisers.

These insights help us to improve both our parent guidance and product development. Under the strict regulations of the „OekoTex Standard 100, product class 1“ and „GOTS“- certificate, our whole collection is produced within the EU. Only by working closely with our partners, we may combine functionality with an ecological mindset.

The “popolini promise” sets a sign for our children's future in a conscious, sustainable world: fair, organic, certified.

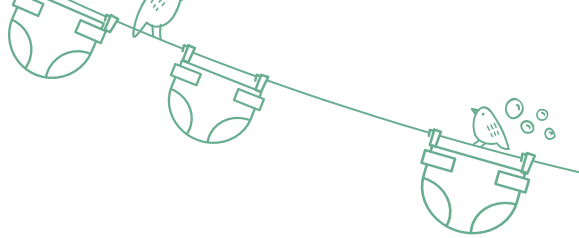

Cloth nappies

Cloth nappies are as easy to use as disposable nappies – but they are washable. Healthy for your baby, environmentally friendly and cheaper than the alternative made of plastic, there are many models and designs you can choose from. For almost 30 years, we have learned a lot accompanying countless parents and babies in growing up. Today we offer a diverse, ecological and modern range of products related to this topic. One baby needs either around 25 cloth nappies or 4.000 disposable nappies. You can decide.



This link leads to the nappy change tutorials:



Systems

2-part system

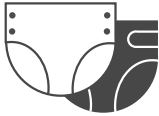

This nappy consists of two parts: absorbent nappy and waterproof cover. The 2-part nappy system can absorb a lot of liquid and is the perfect solution for longer changing intervals or for the night.

2-in-1 system

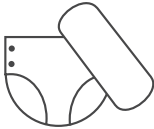

An absorbent core is inserted into the waterproof cover – muslins, prefolds or our particularly absorbent nappy inserts can be used. The volume and suction power of the nappy can be individually adjusted.

3-in-1 system



This system includes three parts. A waterproof pouch is attached to the soft outer nappy and fitted with absorbent inserts. The absorbency of the terry cloth inserts can be increased by inserting booster pads into the provided opening. This slim nappy is particularly breathable.

Basic equipment

2-part system (PapoWrap | Vento | WoolWrap | WoolPant + Newborn MiniFit | Newborn MiniSnap | OneSize | UltraFit | Panda | TwoSize)

3-4 covers and 20-25 absorbent nappies

2-in-1 system* (Snap2Fit + Prefolds | Muslins | Inserts)

3-5 covers and 25-30 absorbent cores

3-in-1 system* (EasyFree)

3 outer nappies, 6 pouches, 25-30 inserts and 25-30 booster inserts

* We recommend using a 2-part system at night. For this purpose 2 additional covers and 4 nappies with inserts are sufficient.

Accessory:

- 1-2 packages nappy liners popli
- 5-10 washing gloves or cleaning wipes
- 2 nappy bags (Rondo) or
- 1 nappy bucket + 2 laundry meshes
- 2 small nappy bags for on the go
- 1-2 washable changing mats

Optional:

- 5-8 Stay-Dry liners
- 1-2 swim nappies
- 2-3 body extensions

Newborn MiniFit



Absorbent nappy for newborns (~2-8 kg | ~4,5-18 lbs)

Adjustable snaps on the front let the Newborn MiniFit grow with your child. The velcro fastener allows stepless closing.

The elastic leg and back ends offer optimal leakage protection - fold the leg ruffles inwards for even more safety.

An absorbent insert to increase the absorbency is included. Nappy cover required - ideally combine with Popo-Wrap in XS. You can find more information in the section 'nappy covers'.

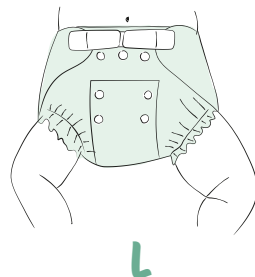
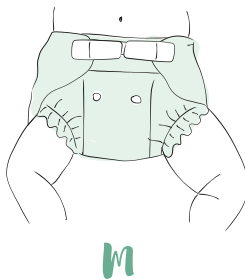
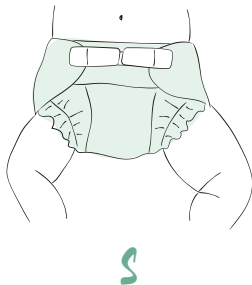

- + slim fitted nappy
- + includes an extra absorbent insert
- + elastic band for high leakage protection around the leg
- + velcro allows variable closing
- + size adjustable
- velcro requires maintenance
- higher purchase costs, because more nappies have to be purchased later

Material options:

Terry Organic: 100% organic* COTTON, GOTS

Terry Soft: 85% organic* COTTON, 15% POLYESTER

(☹ max. 95°C)

* organic cotton = cotton from controlled organic cultivation



This link leads to the nappy change tutorial:

Newborn MiniSnap



absorbent nappy



2-part-system

Absorbent nappy for newborns (~2-8 kg | ~4,5-18 lbs)

Our Newborn MiniSnap is closed with snaps. By folding the front the nappy can be made smaller easily.

The elastic leg and back ends offer optimal leakage protection. An insert to increase the absorbency is included.

Nappy cover required - ideally combine with PopoWrap in XS. You can find more information in the section 'nappy covers'.

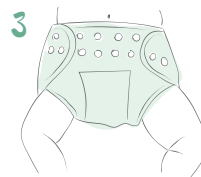
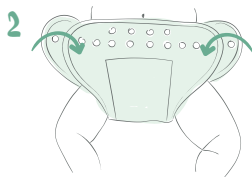
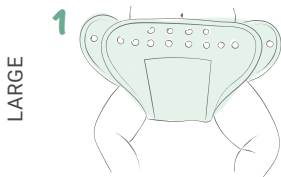
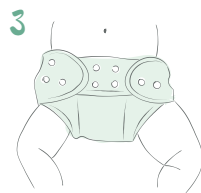
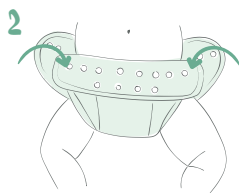
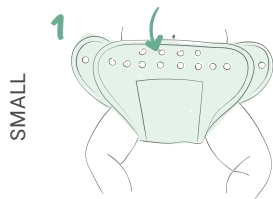

- + slim fitted nappy
- + includes an extra absorbent insert
- + elastic band for high leakage protection around the leg
- + size adjustable
- + snap fasteners do not require special care
- higher purchase costs, because more nappies have to be purchased later

Material options:

Terry Organic: 100% organic* COTTON, GOTS

Terry Soft: 85% organic* COTTON, 15% POLYESTER

(🧺 max. 95°C)

* organic cotton = cotton from controlled organic cultivation



This link leads to the nappy change tutorial:



One sized nappy (~3-15 kg | ~7-33 lb)

The OneSize is closed with snaps. It can be reduced in size by folding the front part downwards. It has to be folded over until the fabric fits well in the crotch.

The OneSize requires a waterproof nappy cover. You can find more information in the section 'nappy covers'.



SMALL

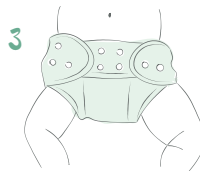
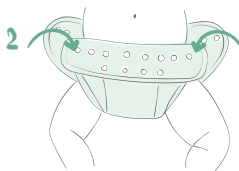
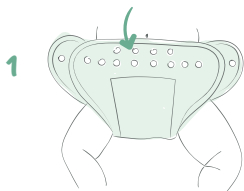

LARGE

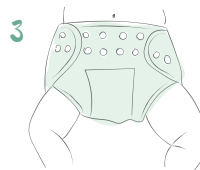
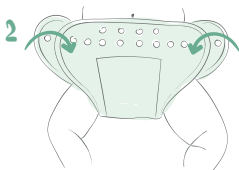
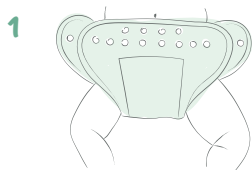

- + perfect night nappy due to high absorbency
- + includes an extra absorbent insert
- + elastic bands for high leakage protection around the legs
- + one sized nappy - low in costs
- + snaps are easy to maintain
- quite large nappy bum (especially for newborns)

Material options:

Terry Organic: 100% organic COTTON

Terry Soft: 85% organic COTTON, 15% POLYESTER

(🧺 max. 95°C)



This link leads to the nappy change tutorial:

UltraFit



absorbent nappy



2-part-system

One sized nappy (~3-15 kg | ~7-33 lb)

The UltraFit is an absorbent nappy that can be adjusted in size with various snaps. It is closed with velcro. Fold leg ruffles inwards so they serve as poo catcher.

The UltraFit requires a waterproof nappy cover. You can find more information in the section 'nappy covers'.



S

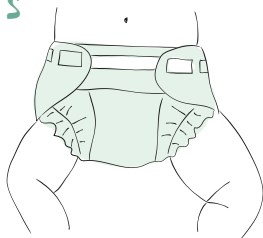

M

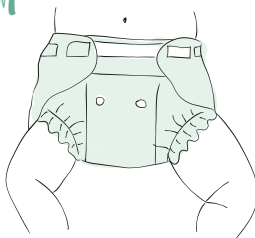

L

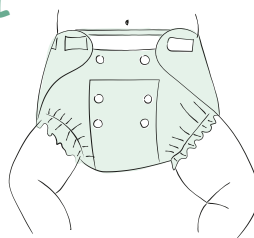

- + perfect night nappy due to high absorbency (especially our terry version)
- + includes an extra absorbent insert
- + elastic bands for high leakage protection around the legs
- + one sized nappy - low in costs
- + velcro allows variable closing
 - quite large nappy bum in the terry version (especially for newborns)
 - velcro requires maintenance

Material options:

Terry Organic: 100% organic COTTON, GOTS

Terry Soft: 85% organic COTTON, 15% POLYESTER

Interlock Soft: 80% organic COTTON, 20% POLYESTER

Tipp: Interlock material is thinner than Terry. It makes the nappy less bulky and more suitable for newborns.

(☹ max. 95°C)



This link leads to the nappy change tutorial:

Panda



absorbent nappy



2-part-system

One sized nappy (~3-15 kg | ~7-33 lb)

The Panda is closed with velcro strips. It can be reduced in size by simply turning it over. If the baby lies elevated due to the folded back part, the front part can be folded over alternatively.

The Panda requires a waterproof nappy cover. You can find more information in the section 'nappy covers'.

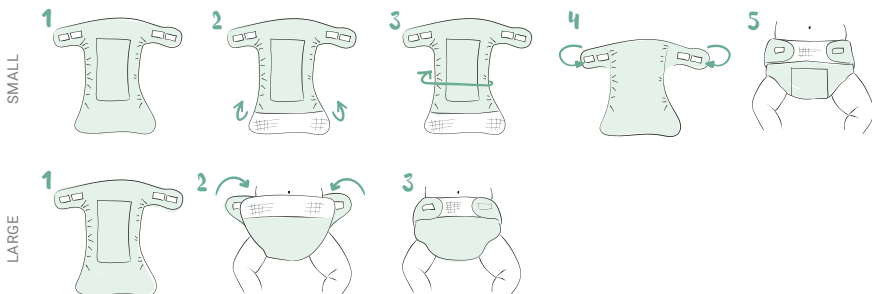

- + our slimmest one sized terry nappy
- + high absorbency
- + includes an extra absorbent insert
- + elastic bands for high leakage protection around the legs
- + one sized nappy - low in costs
- + velcro allows variable closing
- slightly larger nappy bum for newborns
- velcro requires maintenance

Material options:

Terry Organic: 100% organic COTTON

Terry Soft: 85% organic COTTON, 15% POLYESTER

(🧺 max. 95°C)



This link leads to the nappy change tutorial:

TwoSize



absorbent nappy



2-part-system

Sized nappy (**S** ~3-9 kg/~7-20 lb | **L** ~8-15 kg/~18-33 lb
| **XL** ~14+ kg/~31+ lb)

The TwoSize is an absorbent nappy that can be closed with various snaps. It is available in 3 sizes. Fold leg ruffles inwards so they serve as poo catcher.

Size S can be used as a transition nappy until one sized nappies fit perfectly.

The TwoSize requires a waterproof nappy cover. You can find more information in the section 'nappy covers'.



- + slim fitted nappy
- + can be pulled up like a panty when closed
- + high absorbency
- + elastic bands for high leakage protection around the legs
- + snaps are easy to maintain
- requires several sizes
- no extra absorbent insert included

Material options:

Terry Organic: 100% organic COTTON

Terry Soft: 85% organic COTTON, 15% POLYESTER

(☹ max. 95°C)

This link leads
to the nappy
change tutorial:





Prefold



Prefolded square of cotton fabric

S 30x41 cm | **M** 34x47 cm | **L** 39x53 cm

This option is a real multi-talent! You can either fold it as a nappy (graphic 1) and combine it with a waterproof cover, create an absorbent inlay (graphic 2) to support knitted nappies, or simply place it into a nappy cover.

Our Prefold consists of 3 segments: 8 fabric layers in the middle part and 4 layers on each side. That makes it particularly easy to fold.

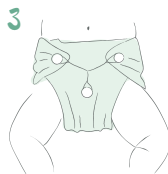
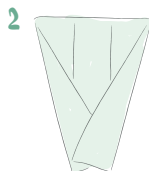
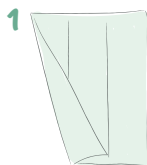

graphic 1: folding an absorbent nappy with the help of a Snappy fastener

1



2



3



graphic 2:
folding an inlay

- + individually adaptable through various folding techniques
- + high absorbency
- + slim nappy bum
- + simple folding
- requires several sizes

Material: 100% organic* COTTON, GOTS

(☒ max. 95°C)

* organic cotton = cotton from controlled organic cultivation

Knitted nappy



One sized nappy (~3-15 kg | ~7-33 lb)

This nappy can be reduced in size through simple folding and reinforced with individual absorbent inserts. It is closed with ribbons.

The knitted nappy requires a waterproof nappy cover. You can find more information in the section 'nappy covers'.



- + the knitted texture adjusts perfectly to the body
- + individually adaptable absorbency
- + one sized nappy – low in costs
- requires a bit of practice
- not appropriate for highly mobile babies
- before washing, the ribbons need to be tied or weaved together

Material:

100% organic COTTON

(🧺 max. 60° C)

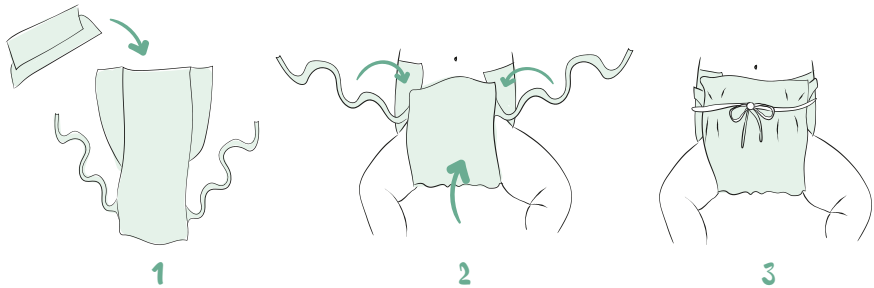

GENERAL TIPS FOR CLOTH NAPPIES

- for maximum absorbency, wash any new cloth nappy at least three times before its first use
- apply inserts to further increase absorbency – especially during the night
- make sure the material lies well inside your child's leg folds
- cloth nappy bums need more space – choose clothing sizes accordingly
- check the nappy cover edges for out-sticking material around the legs and in the back
- close all velcros before washing and clean them from time to time
- after washing, pull the nappy into form while still wet

EasyFree

S ~2,5-5 kg/~5,5-11 lb | **M** ~4,5-10 kg/~10-22 lb |

L ~9-15 kg/~20-33 lb

The EasyFree is a hybrid nappy, consisting of 3 parts:

- The outside nappy offers stability and an optimal fit.
- The PU-coated pouch serves as a waterproof barrier. It is snapped into the outside nappy.
- An insert inside the pouch absorbs moisture. An additional booster can be added to increase absorbency.



For easy-potting with elimination communication babies, you simply hook up the W-free belly strap to the outside nappy. It offers you to open and close the EasyFree within seconds.

Material options:

Cover: 100% organic COTTON (☹ max. 40°C),
100% organic MERINO WOOL (hand wash), mulesing free

Pouch: 100% POLYESTER with polyurethane coating (☹ max. 60°C),
100% organic MERINO WOOL (hand wash), mulesing free

Liner: absorbent core: 50% POLYESTER, 50% VISCOSE,
outer layer: 100% organic COTTON TERRY (☹ max. 95°C)

Booster: absorbent core: 50% POLYESTER, 50% VISCOSE,
outer layer: 100% organic COTTON TERRY (☹ max. 95°C)

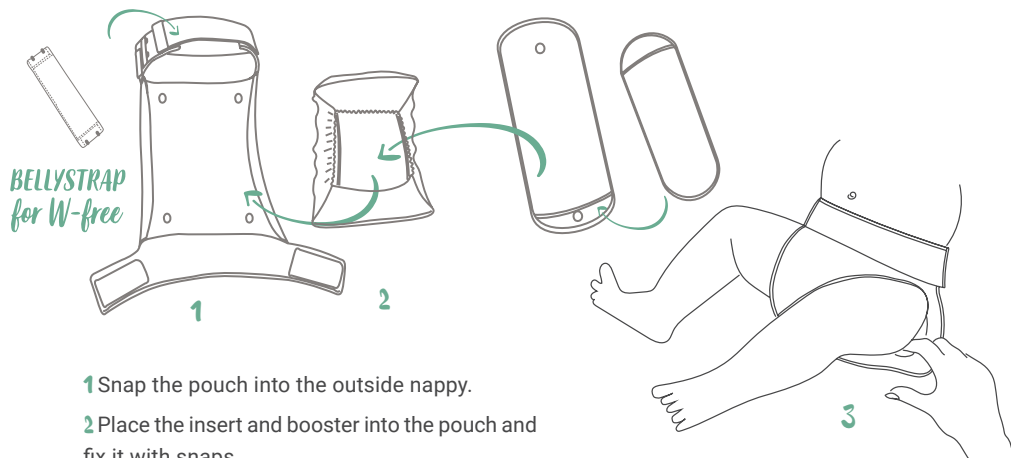

- 1 Snap the pouch into the outside nappy.
- 2 Place the insert and booster into the pouch and fix it with snaps.
- 3 After closing the nappy, move your finger along the pouch's edge for a perfect fit.

- + for full use or elimination communication
- + simple nappy change
- + 3 sizes for an optimal fit
- + slim nappy bum

- + individually adaptable absorbency
- + reduced laundry – for the environment
- short changing intervals recommended
- requires several sizes



This link leads to the nappy change tutorial:

PERSONAL TIPS FOR THE EASYFREE:

- The offered size/weight information is a guide value. Every child has a different shape.
- Most babies wear M longer than other sizes.
- Moving on from "S" to "M", or from "M" to "L", the smaller sized pouch might still seal better for some time (e.g. M pouch fits in L nappy).
- Some babies move up to size "L" around 8 months. Yet when mobility increases, they come back down to size "M".
- You can also use prefolds or muslins as absorbent inlays.
- The inserts will reach their maximum absorbent capacity after approx. 7 washes.
- The wool version of the outside nappy offers, compared to the cotton version, a second leakage protection.
- **For elimination communication**, we recommend using our baby leg warmers or EasyFree Crawlers.
- The EasyFree inserts can be snapped into the pouch to prevent them from falling out during easy-potting.



Nappy covers:

Nappy covers offer leakage protection and serve as a moisture barrier. When changing nappies, please make sure that they fully enclose the absorbent material on all edges! All our covers are Oekotex Standard 100, product class 1 certified. We distinguish between PU-coated covers and those made from wool.

Our PU-covers from 100% polyester are coated with polyurethane. That makes them especially leakproof, durable, and heat-resistant compared to conventional polyurethane laminated (PUL) covers. They dry quickly and you can simply wipe them off instead of renewing them at every nappy change.

Our wool covers offer an optimal moisture barrier without using any synthetic fibers. They can absorb wetness without feeling damp. The natural material has an antibacterial and self-cleaning effect, which requires less washing. After usage, it's often enough to ventilate the material. It can be newly impregnated with a lanolin wool cure if moisture gets through the cover. You can find more information about the maintenance of wool covers on page 42.

PopoWrap



XS ~2-4 kg | **S** ~3-6 kg/~7-13 lb | **M** ~5-10 kg/~11-22 lb |
L ~9-15 kg/~20-33 lb | **XL** ~14+ kg/31+ lb

The PopoWrap is a PU (polyurethane) coated cover with double elasticated leg cuffs. It is closed with velcro and can be wrapped over any absorbent washable nappy. For an optimal fit with newborn nappies, the PopoWrap in size XS can be adjusted in size by using snaps on the front.



- + multiple sizes offer a perfect fit
- + to be combined with any absorbent nappy
- + velcro allows variable closing
- covers in several sizes needed
- velcro requires more maintenance than snaps

Material: 100% POLYESTER with polyurethane coating

Vento



S ~3-6 kg/~7-13 lb | **M** ~5-10 kg/~11-22 lb |
L ~9-15 kg/~20-33 lb | **XL** ~14+ kg/31+ lb

The Vento is a PU (polyurethane) coated cover with simple leg cuffs. It is closed with snaps and can be wrapped over any absorbent washable nappy.



- + multiple sizes offer a perfect fit
- + to be combined with any absorbent nappy
- + snaps are not as easily opened by your little one
- + can be pulled up like a panty when closed
- + the elastic band around the belly is optimal when your baby sleeps on the stomach
- covers in several sizes needed
- not steplessly adjustable

Material:

100% POLYESTER with polyurethane coating

(☹ max. 60°C)

Snap2Fit



Size-adjustable nappy cover (~4 -15 kg | 9-33 lb)

The Snap2Fit is a breathable and particularly slim cover that grows with the child. Prefolds, muslins or other absorbent boosters can be inserted into the practical flaps on the inside - so the Snap2Fit can easily be adapted to the changing needs of the baby.

Closure and size adjustability with snaps.

Tip: transform the Snap2Fit closure into a velcro closure with the Snap-on velcro (not included!).



- + slim fit
- + economical, as it is size adjustable
- + the tabs prevent the inserts from slipping
- + easy changing, as no extra absorbent nappy has to be closed
- + the optional velcro fastener can be removed for the wash cycle
- no optimal cover for fitted nappies
- the cover gets easier spoiles with poo than with fitted nappies

Material:

Cover: 100% POLYESTER with polyurethane coating

Flaps: outer: Stay-Dry 100% POLYESTER

inner: 100% POLYESTER with polyurethane coating

(☹ max. 60° C)



This link leads to the nappy change tutorial:

WoolWrap



S ~3-6 kg/~7-13 lb | **M** ~5-10 kg/~11-22 lb |
L ~9-15 kg/~20-33 lb | **XL** ~14+ kg/31+ lb

The WoolWrap is a natural and especially breathable cover made of tumbled wool. It is closed with Velcro and can be wrapped over any absorbent washable nappy.



- + especially breathable
- + multiple sizes guarantee a perfect fit
- + to be combined with any absorbent nappy
- + velcro allows variable closing
- + optimal cover for the night
- + after usage without poo contact – air out after use
- + washing only every 2-3 weeks
- covers in several sizes needed
- velcro requires maintenance
- wool needs to be washed separately
- regular wool cures (more on page 38)
- looks bulkier than PU-covers

Material: 100% WOOL
(hand wash)

WoolPant



62/68 ~3-6 kg/~7-13 lb | **74/80** ~5-10 kg/~11-22 lb |
86/92 ~9-15 kg/~20-33 lb | **98/104** ~14+ kg/31+ lb

The WoolPant is a double knitted cover made of wool. It is a natural and especially breathable moisture protection and can be worn over any absorbent nappy.

A new WoolPant has to be washed and impregnated several times until it seals perfectly.



- + especially breathable
- + multiple sizes guarantee a perfect fit
- + doesn't leave any marks on the edges
- + to be combined with any absorbent nappy
- + after usage without poo contact – air out after use
- + washing only every 2-3 weeks
- covers in several sizes needed
- wool needs to be washed separately
- regular wool cures (more on page 38)
- looks bulkier than PU-covers

Material: 100% organic WOOL
(hand wash)



Inserts

Size: ~30x12 cm

Absorbent inserts supplement any cloth nappy system to increase their absorbency. They are an optimal addition for the night.

Material options:

Organic: 100% organic COTTON, GOTS (☞ max. 95°C)

Soft: 85% organic COTTON, 15% POLYESTER (☞ max. 95°C)

Stay-Dry: 1 layer Stay-Dry material: 50% POLYESTER,
40% POLYPROPYLEN, 10% ELASTAN

1 layer super absorber: 50% POLYESTER, 50%
VISCOSE

1 layer Interlock Soft: 80% organic COTTON, 20%
POLYESTER (☞ max. 60°C)



Snappi nappy fastener

Length: ~13 cm

Snappy is an elastic nappy fastener for closing prefolds or muslins.

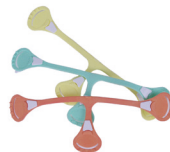

Popli nappy liners

Nappy liners help to catch poo and make it easy to remove. It can also be used as cleaning- or wet wipe. It is compatible with any cloth nappy system and it protects the material from coarse dirtiness.

Usage: Place the liner as a top layer into the nappy. During nappy changes, simply remove the dirty liner into the bin.

Role

Size: 16x28 cm

Popli nappy liners facilitate the disposal of poo.

Material: CELLULOSE, 80% biodegradable



Box

Size: 24x34 cm

Popli nappy liners facilitates the disposal of poo of a weaned child.

Material: 100% VISCOSE, 80% biodegradable



Stay-Dry liner

Size: ~34x18 cm

Our Stay-Dry liner can be used instead of the cellulose liner. It keeps your child from being moist longer, as it quickly carries wetness into the absorbent part while still feeling dry. It's an optimal addition for the night. Possible poo is removed into the toilet; the cloth is washed.

Material: 50% POLYESTER, 40% POLYPROPYLEN,
10% ELASTHAN (👉 max. 60°C)



Bourette silk liner

Size: 1 ~15x24 cm | 2 ~15x45 cm

The bourette silk liner supports healing irritated skin as it's material has an anti-inflammatory and cooling effect. It is placed as a top layer into the nappy. Possible poo is removed into the toilet; the inlay needs to be washed by hand.

Material: 100% BOURETTE SILK (👉 max. 30°C)



Nappy washing instructions



COLLECT

- dispose the dirty nappy liner
- close all velcros to avoid fibers getting caught
- collect used nappies in a wet bag or nappy bucket
- do not soak in water and store for max. three days

WASH

- load the washing machine as full as possible
- use a pre-wash program to rinse urine and poo
- select program for cotton or colored clothes, no eco programs
- we recommend washing at 40-60°C – check instructions on the care label
- use skin- and environmentally friendly detergent
- use the recommended amount of detergent
- do not use fabric softener – it reduces the absorbency of the nappy
- occasionally use ecologically harmless decalcifier for hard water
- treat stains with sunlight exposure or natural stain remover



DRY

- pull into shape while still wet
- dry completely
- if using a dryer, choose a delicate program



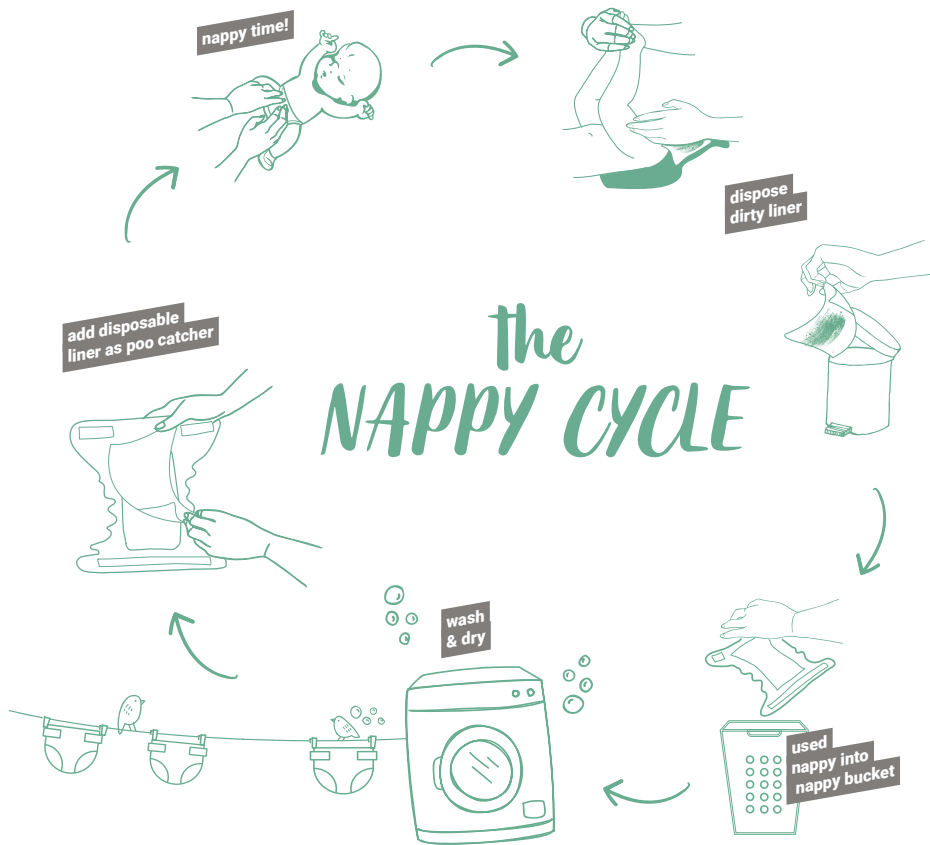

Wool care instructions

WASH

- air well after use
- when damp, hang out to dry
- approx. every 2 - 3 weeks wash & re-grease
- hand wash with mild or wool detergent; our recommendation: Ulrich natürlich delicate detergent
- after washing, pull well into shape and let dry lying down

LANOLISING

- our recommendation: Ulrich natürlich wool cure
- mix wool cure under instructions with hot water & let cool down
- place previously washed wool cover in the mixture and soak for 4-6 hours
- press out moisture, do not wring
- pull well into shape and let dry lying down
- do not leave to dry in the sun or on a radiator to protect the wool fibres
- you need several washing and impregnation processes until a new pair of wool covers can be used

For further questions please do not hesitate to contact us:

+43 (0) 1 803 87 67

info@popolini.com

Our certificates

Every year our products have to pass the approval of highly stringent eco audits. Have a look at our brief introduction of the signs and certifications you can currently find on our products:



Our textile products (including those with synthetic fibres) are certified according to Oeko-Tex Standard 100 product class 1 (baby and infant). Therefore these products are poor in harmful residues. Our certification number is : OETI N° 46490. More info: www.oeko-tex.com

GOTS, the Global Organic Textile Standard is worldwide recognised as a leading standard which defines high level environmental criteria along the entire supply chain of organic textiles and requires compliance with social criteria as well. Our products are certified under: Ecocert Greenlife N° 151806. Read more: www.global-standard.org



Fair



Organic



Certified

Company stamp



9 006720 103657 >



Eigner Druck GmbH, 3040 Neulengbach, gedruckt nach der Richtlinie
„Druckerzeugnisse“ des Österreichischen Umweltzeichens, UW 981

popolini.com  **popoliniorganic**  **@popolini_organic**  **popolini_organic**

BMK Handels- und Vertriebs GmbH | Schuhfabrikgasse 17/2 | 1230 Vienna, Austria